

# ecofrost

**7063.0015**

**v1.0**

Onderdelen informatie  
Erzatzteil information  
Spare part information  
Information de pièces





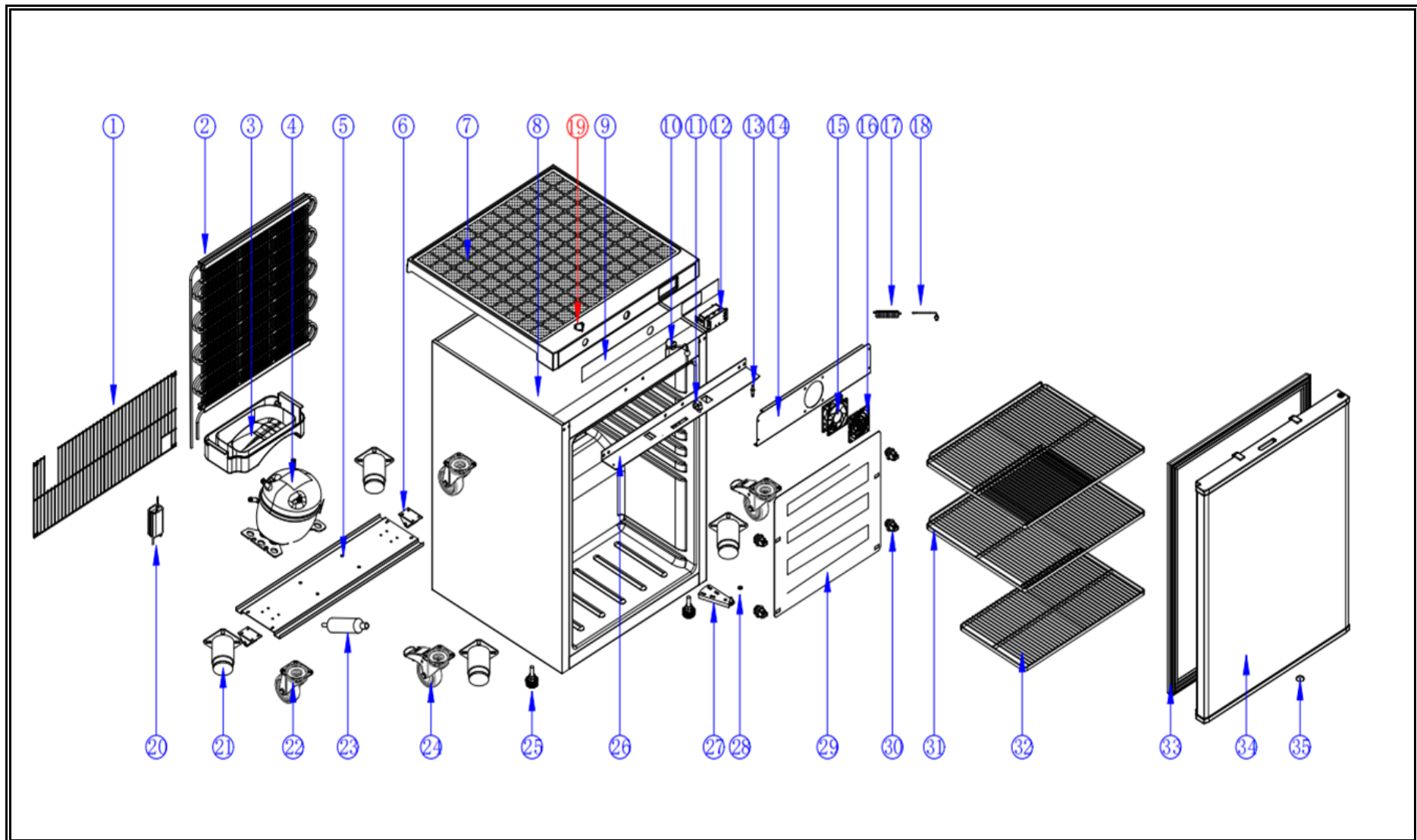

POS:	Art.No.:	Omschrijving:	Aantal:
1		Engine room grid	1
2		Condenser	1
3	CS9338.8018	Evaporating pan	1
4		Compressor	1
5		Bottom plate of compressor	1
6		Rollers	2
7		Top panel	1
8		Body	1
9	CS9338.8034	Control panel label	1
10	CS9338.8008	Lock with 2 keys	1
11	CS9338.8002	Door switch	1
12	CS9338.8004	Thermostat DT-02	1
13	CS9338.8026	Hinge axis/pivot	1
14		Evaporator fan baffle	1
15	CS9338.8016	Evaporator fan	1
16		Evaporator fan net cover	1
17		Probe fixing cover	1
18	CS9338.8014	Senser/Probe/Thermistor	1
19	CS9338.8012	Main switch	1
20	CS9338.8036	Switching power supply	1
21		201# SS feet	4
22		Big castor(without brake)	2
23		Dry filter	1
24		Big castor(with brake)	2
25	CS9338.8006	Feet	2
26		Top bracket	1
27		Down hinge	1
28	CS9338.8022	Nylon washer	1
29		Roll-bond evaporator	1
30		Evaporator fastener	4
31	CS7063.9005	Upper shelf	2
32		Bottom shelf	1
33	CS9338.8010	Door gasket	1
34		Foamed door-SS	1
34		Foamed door- white PCM	1
35	CS9338.8028	Foaming hole cover for door	1



The logo for ecofrost features the word "ecofrost" in a bold, blue, sans-serif font. Above the letter "o" in "eco", there is a stylized graphic element consisting of a light blue arc and a dark blue four-pointed starburst.

**ecofrost**

**7063.0015**

## **Combisteel BV**

Lichtschip 63  
3991CP Houten  
The Netherlands

+31 (0)30 285 00 90  
[info@combisteel.com](mailto:info@combisteel.com)  
[www.combisteel.com](http://www.combisteel.com)