

ecofrost

7950.5040

R290

Onderdelen informatie
Erzatzteil information
Spare part information
Information de pièces



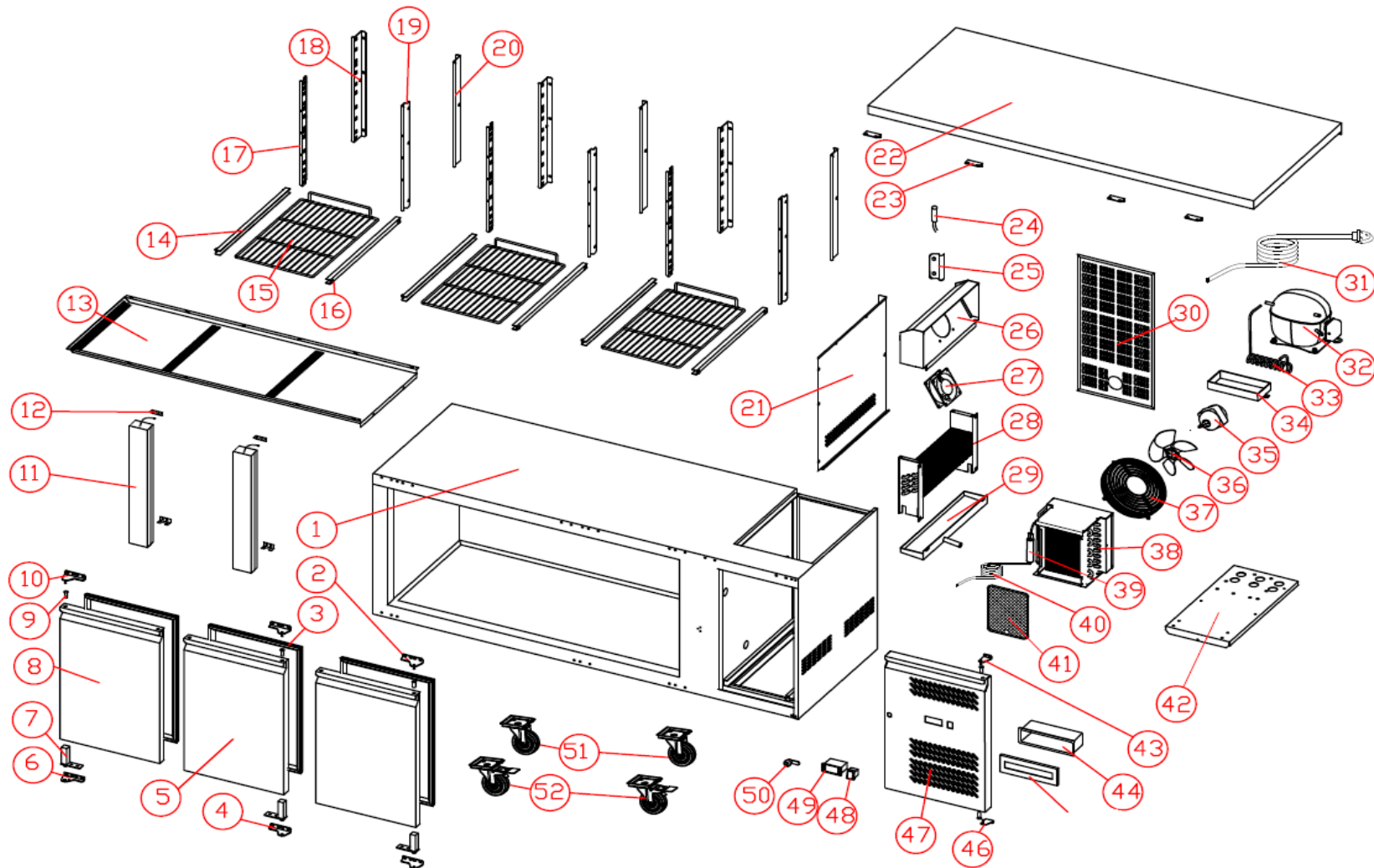

| POS: | Art.No.: | Omschrijving: | Aantal: |
|------|-----------|---------------------------|---------|
| 1 | | cabinet | 1 |
| 2 | 9338.3905 | right upper hinge | 2 |
| 3 | 9338.3350 | door gasket | 3 |
| 4 | 9338.3910 | right bottom hinge | 2 |
| 5 | 9338.3755 | door(right) | 2 |
| 6 | 9338.3920 | left bottom hinge | 1 |
| 7 | 9338.3080 | spring hinge | 3 |
| 8 | 9338.3780 | door(left) | 1 |
| 9 | 9338.3275 | door axis sleeve | 5 |
| 10 | 9338.3915 | left upper hinge | 1 |
| 11 | | middle beam | 2 |
| 12 | | middle beam connect | 4 |
| 13 | | air guide board | 1 |
| 14 | | left shelf guide | 3 |
| 15 | 9338.3025 | shelf | 3 |
| 16 | | right shelf guide | 3 |
| 17 | | beam hang strip(left) | 3 |
| 18 | | rear hang strip(left) | 3 |
| 19 | | beam hang strip(right) | 3 |
| 20 | | rear hang strip(right) | 3 |
| 21 | | fan cover | 1 |
| 22 | | counter top | 1 |
| 23 | | top fixing plate | 4 |
| 24 | 9338.3515 | probe | 1 |
| 25 | | probe cover | 1 |
| 26 | | eva. Fan cover | 1 |
| 27 | 9338.3540 | eva. Fan | 1 |
| 28 | 9338.3475 | evaporator | 1 |
| 29 | 9338.3220 | evapotaror drain pan | 1 |
| 30 | | back cover | 1 |
| 31 | 9338.3530 | power cord | 1 |
| 32 | 9338.3425 | compressor | 1 |
| 33 | 9338.3960 | high pressure pipe | 1 |
| 34 | 9338.3225 | outer drain pan | 1 |
| 35 | 9338.3270 | cond. Fan motor | 1 |
| 36 | 9338.3215 | cond. Fan blade | 1 |
| 37 | 9338.3585 | cond.fan cover | 1 |
| 38 | 9338.3450 | condenser | 1 |
| 39 | 9338.3370 | dryer filter | 1 |
| 40 | 9338.3185 | capillary | 1 |
| 41 | 9338.3260 | dryer filter | 1 |
| 42 | | cooling unit board | 1 |
| 43 | 9338.3925 | control panel upper hinge | 1 |

| POS: | Art.No.: | Omschrijving: | Aantal: |
|------|-----------|-------------------------------|---------|
| 44 | 9338.3930 | plastic water-proof box | 1 |
| 45 | 9338.3935 | plastic water-proof box cover | 1 |
| 46 | 9338.3940 | control paner bottom hinge | 1 |
| 47 | | panel | 1 |
| 48 | 9344.0105 | power switch | 1 |
| 49 | 9338.3545 | controller | 1 |